

Model: RH24

DATA SHEET

- ❖ Automatic in-car air freshener
- ❖ Standard scented gel pack commonly available in variety of scents
- ❖ Long lasting easily replaceable gel packs
- ❖ Scent is circulated only when lift is active
- ❖ User adjustable scent dosage
- ❖ LED indication for low/empty gel pack
- ❖ User activation possible by double pressing main floor button
- ❖ Simple to install, just three wires (two for power supply, one to pushbutton)
- ❖ Operates on any pushbutton system
- ❖ Operates on 24VAC/DC

Description

The Lift Air Freshener is designed to ensure that lift cars are kept free of unpleasant odours by circulating scented air within the car.

The RH24 consists of an airtight plastic box which contains the gel pack, the electronic circuitry and an air-line which carries the scented air to the lift car. The scented air is propelled by a small fan located at the rear of the box.

The RH24 circulates a measured dose of scented air, the dosage is adjusted via the trim pot on the circuit board. The frequency of the doses is not user adjustable and is preset to one dose for each six journeys to the main floor (or any other selected floor).

As well as the regular doses according to journey frequency the RH24 can be instructed to deliver a dose at the time of the user's choosing by pressing the main floor call button twice **only when the car is stationary at the main floor.**

The gel pack is a low cost air freshener, which is available in a variety of scents.

The RH24 has an LED lamp which will flash when the gel pack is depleting and the time for replacement is close.

When replacing (or installing for the first time) the gel pack please press the S1 (reset button) on the circuit board in order to reset the internal dose counter. Reset is acknowledged by flashing the LED twice.

The RH24 has four terminals:

- 1 IN- : Car call push button
(Usually main floor button) - when car call is pushed it applies GND potential to this input.
- 2 IN+ : +24VDC from pushbutton supply.
- 3 24VDC or AC : Power Supply
- 4 24VDC or AC : Power Supply

The RH24 is fastened to the car top via two self-drilling screws (which are supplied with the unit).

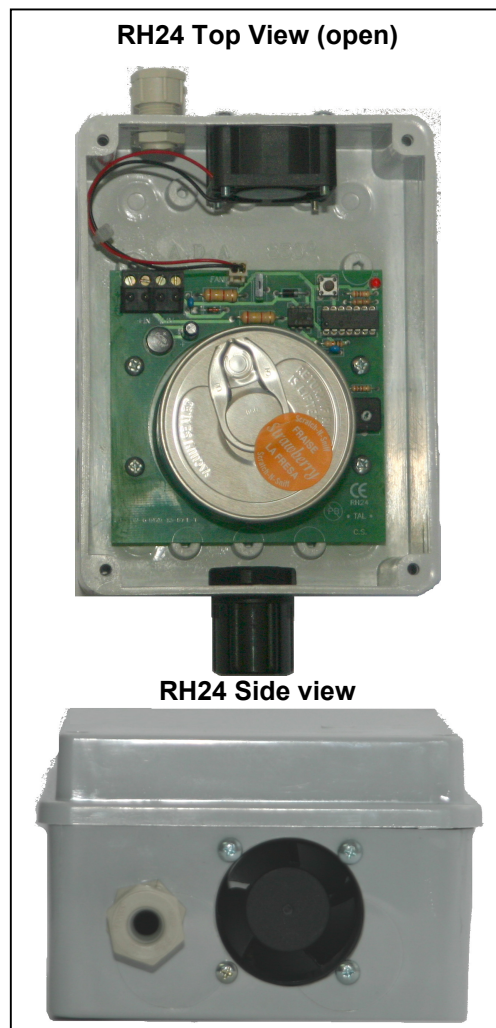

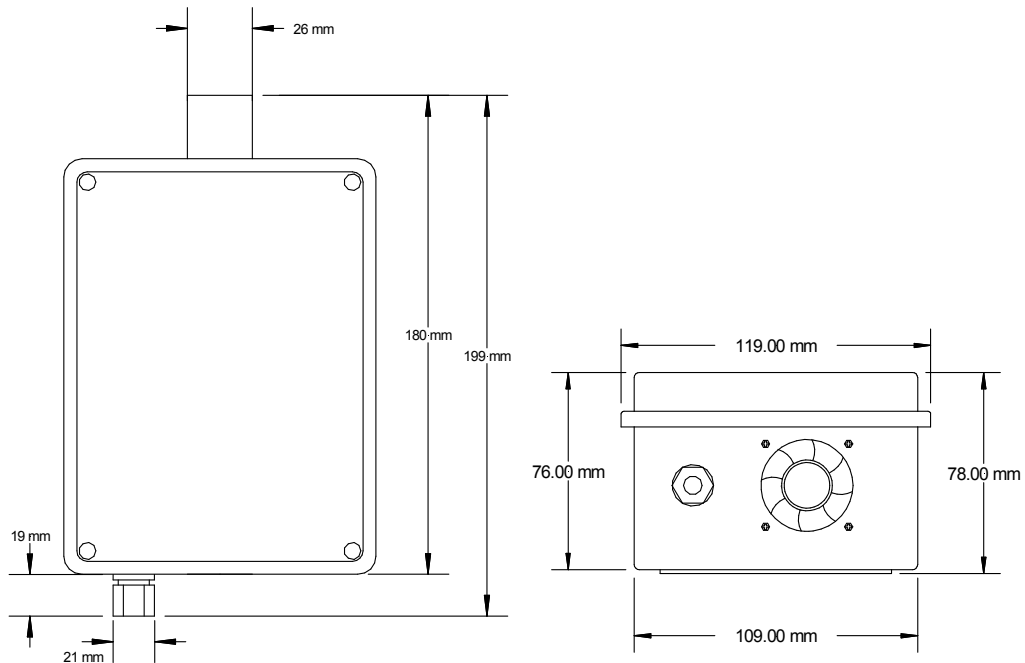
Dimension Diagram

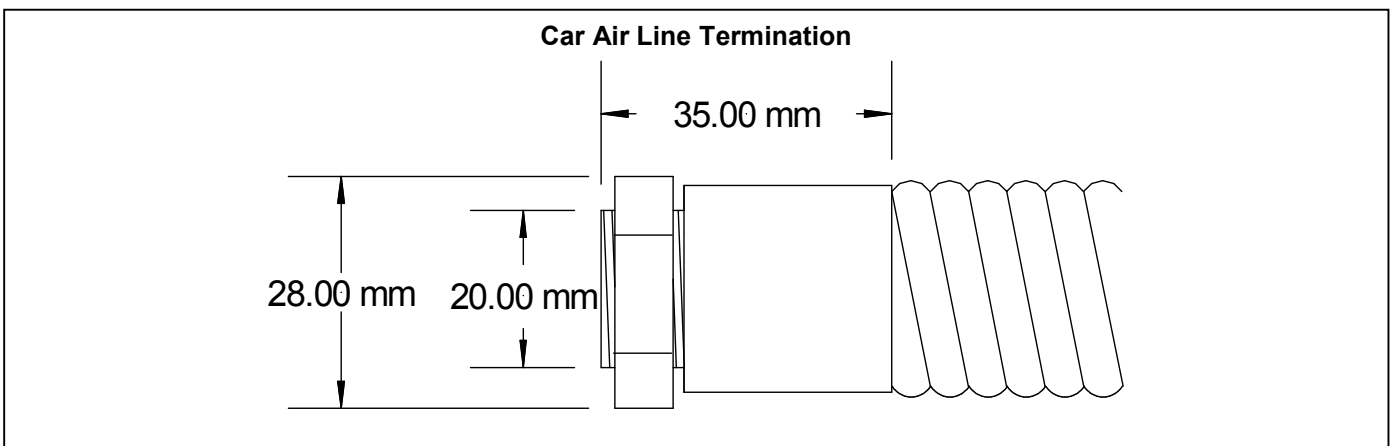
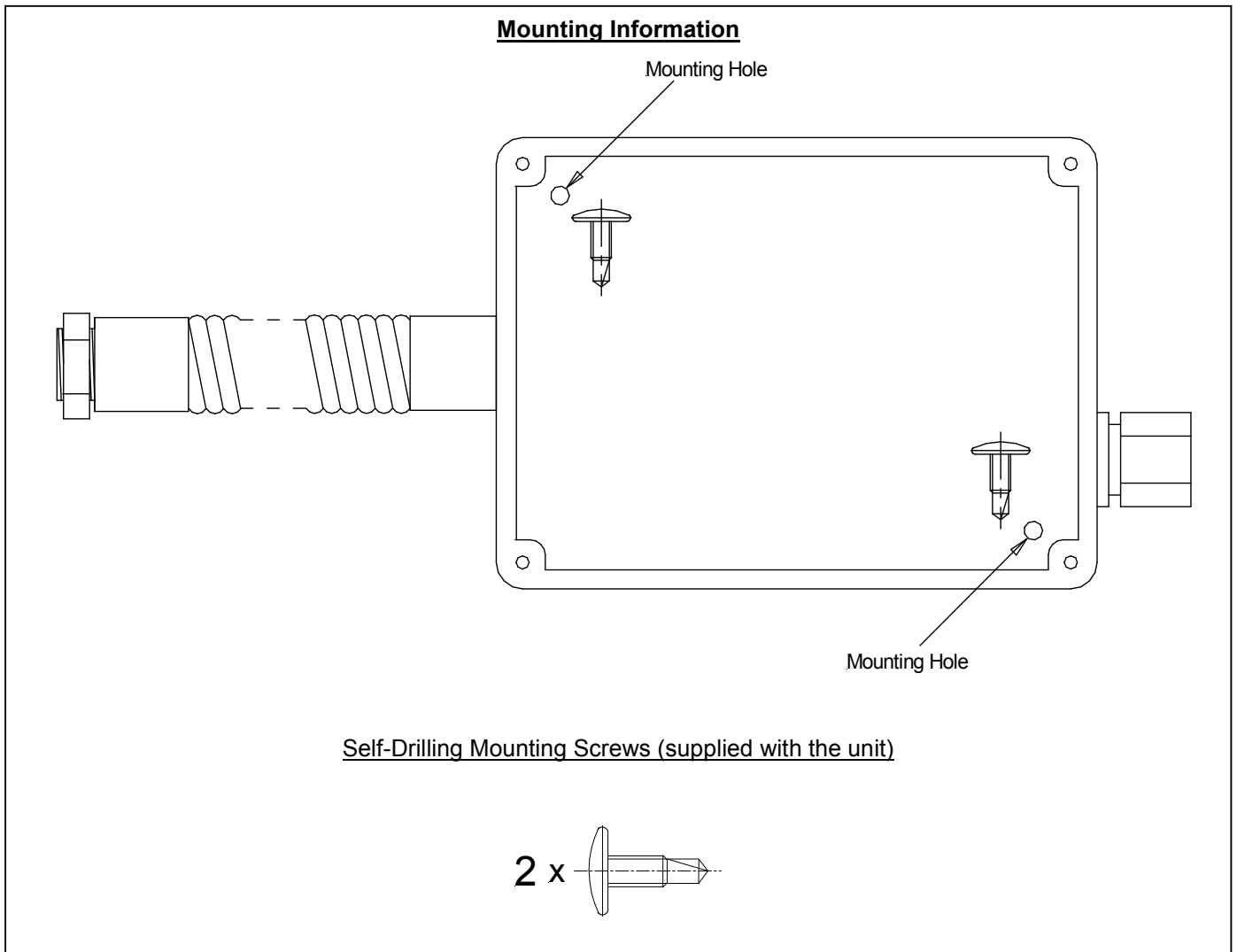

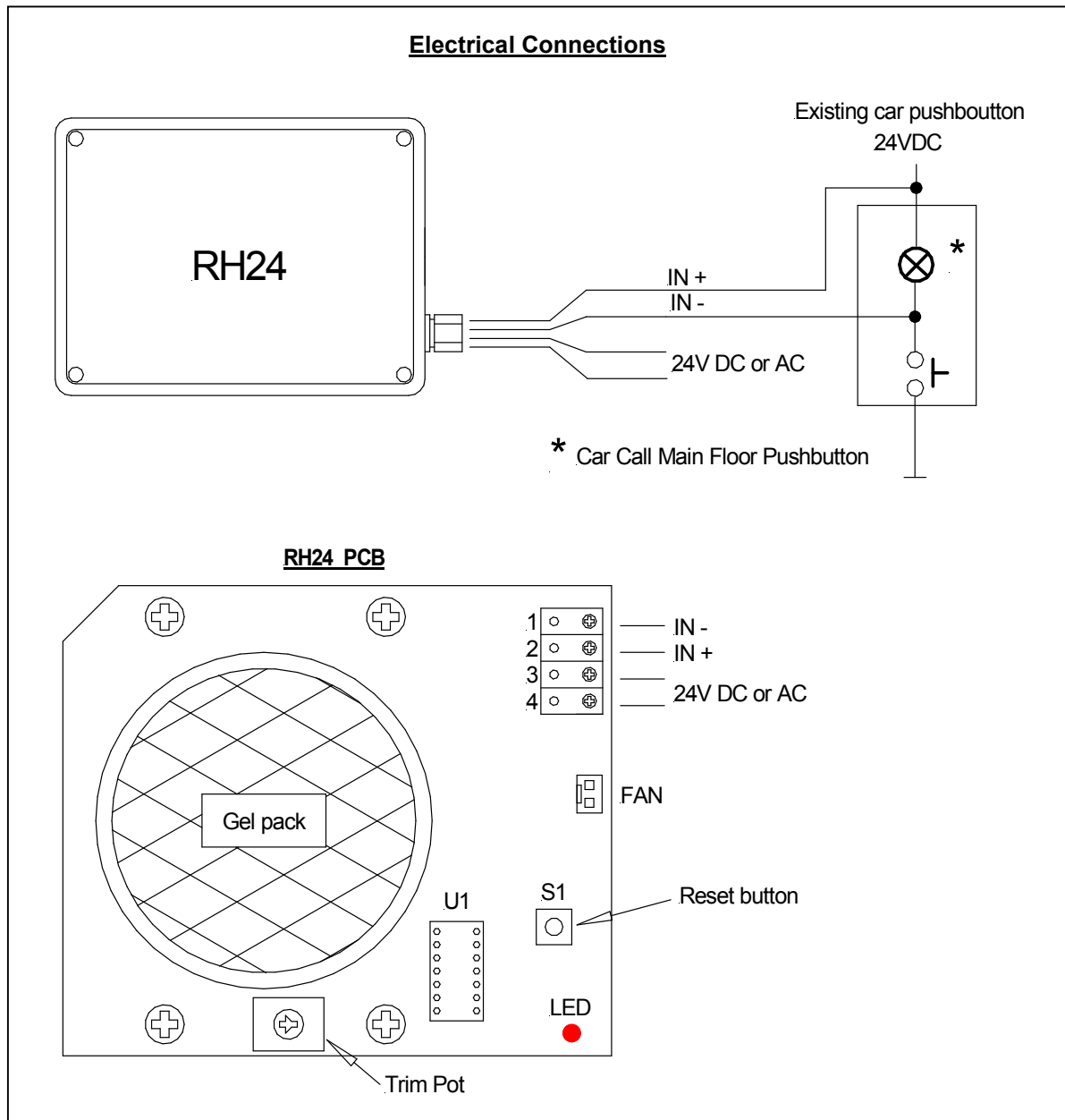
**Specifications**

Power Supply:	24VDC (18- 32 VDC) or 24VAC @ 150mA max.
Dose Size:	5 to 60 seconds, user definable.
Dose Frequency:	One in six travels to main floor (or other selected floor)
Freshener:	Gel pack, scent is broadcast by sublimation.
Average lasting time of container:	60-90 days (dependant on number of starts)
Container Dimension:	183mm x 119mm
Air Line:	Diameter: 25mm Length: 310mm
Weight:	600gr

Ordering Information

RH24	Elevator Air Freshener with 1 metre air line.
RH24-X	Elevator Air Freshener with X metre air line.